

Studio Theatre: Seating Layout A

Drawn by The Point Technical Department

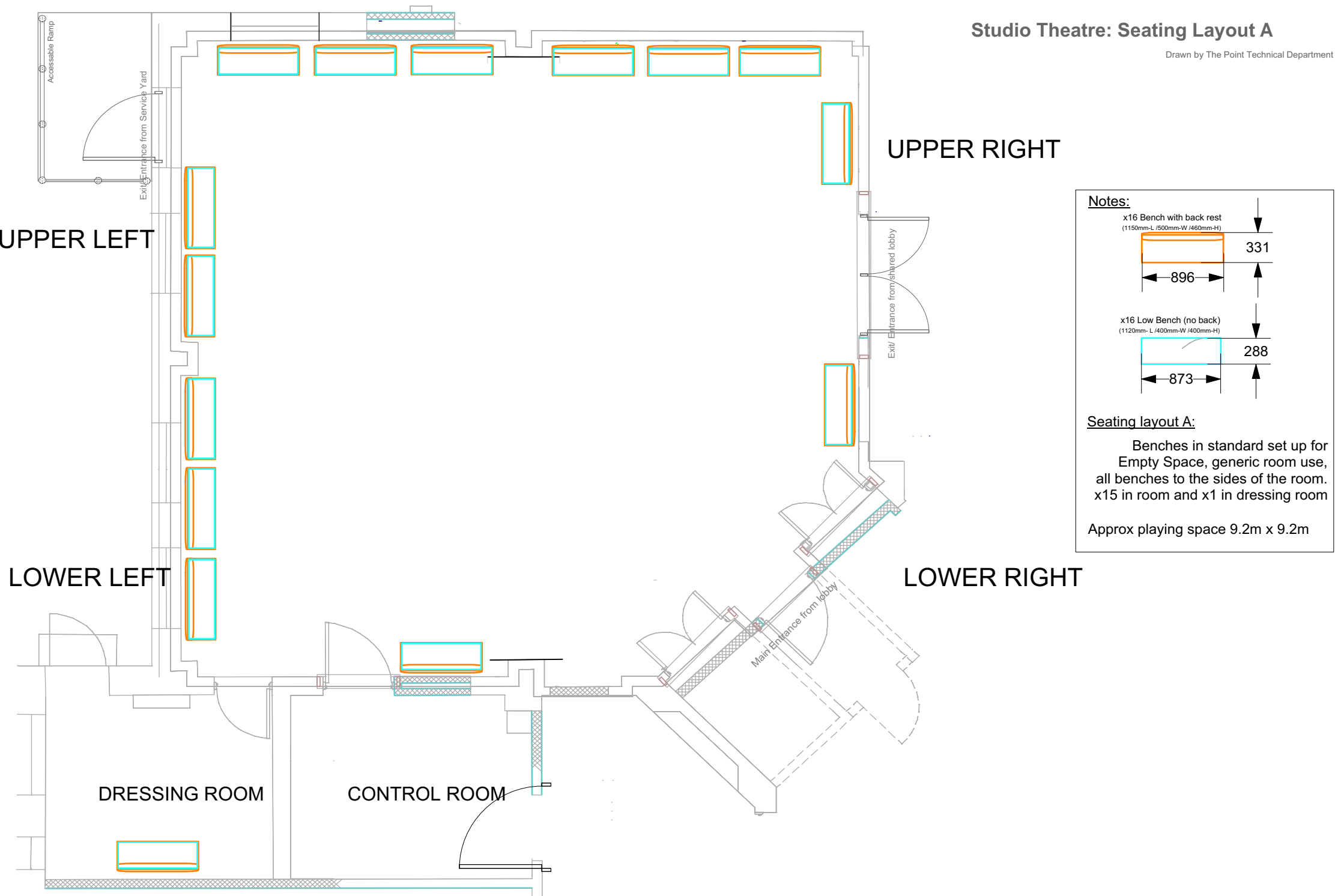

Studio Theatre: Seating Layout B

Drawn by The Point Technical Department

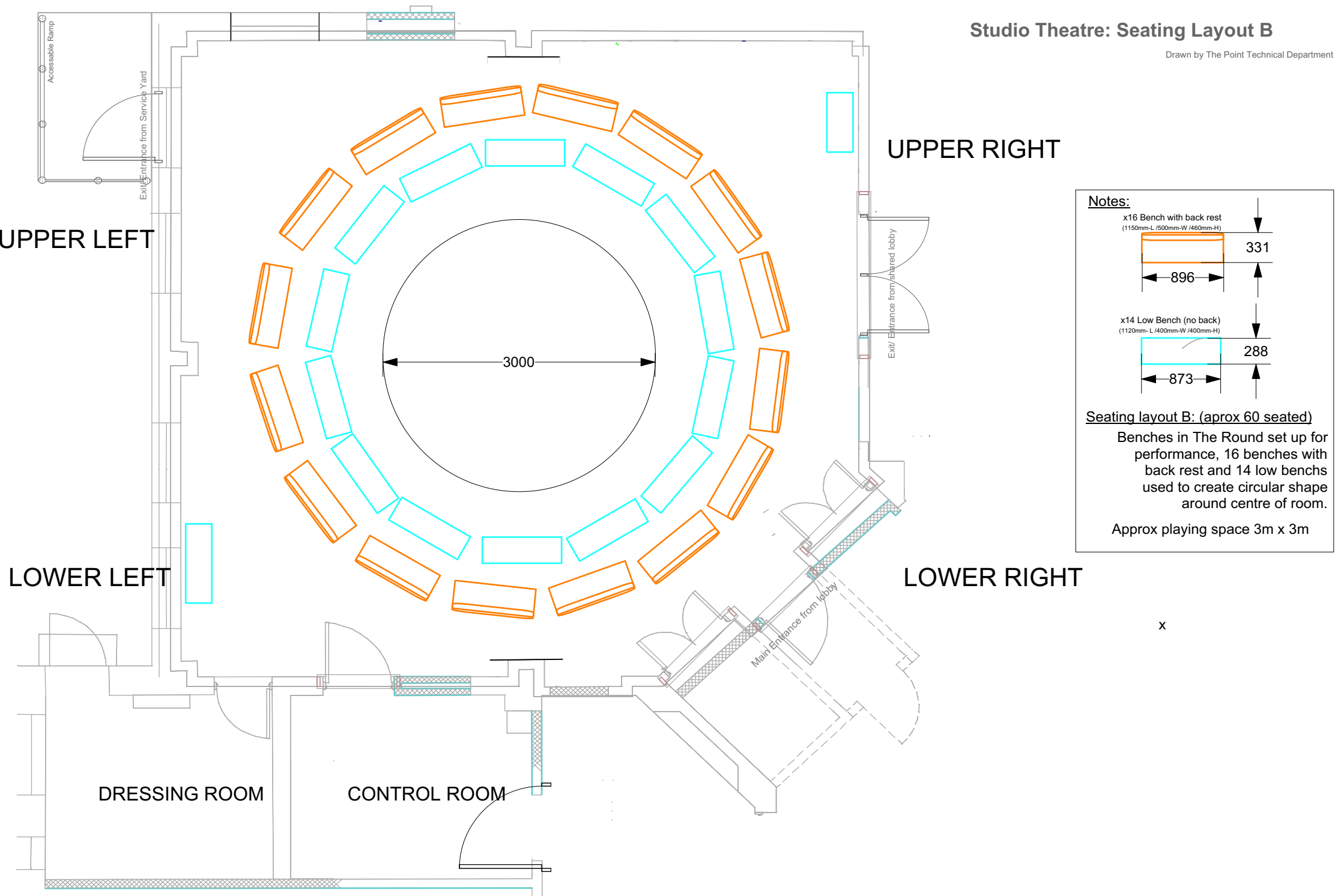

Notes:

x16 Bench with back rest
(1150mm-L /500mm-W /450mm-H)
331
896

x14 Low Bench (no back)
(1120mm- L /400mm-W /400mm-H)
288
873

Seating layout B: (aprox 60 seated)
Benches in The Round set up for performance, 16 benches with back rest and 14 low benches used to create circular shape around centre of room.
Approx playing space 3m x 3m

x

Studio Theatre: Seating Layout C

Drawn by The Point Technical Department

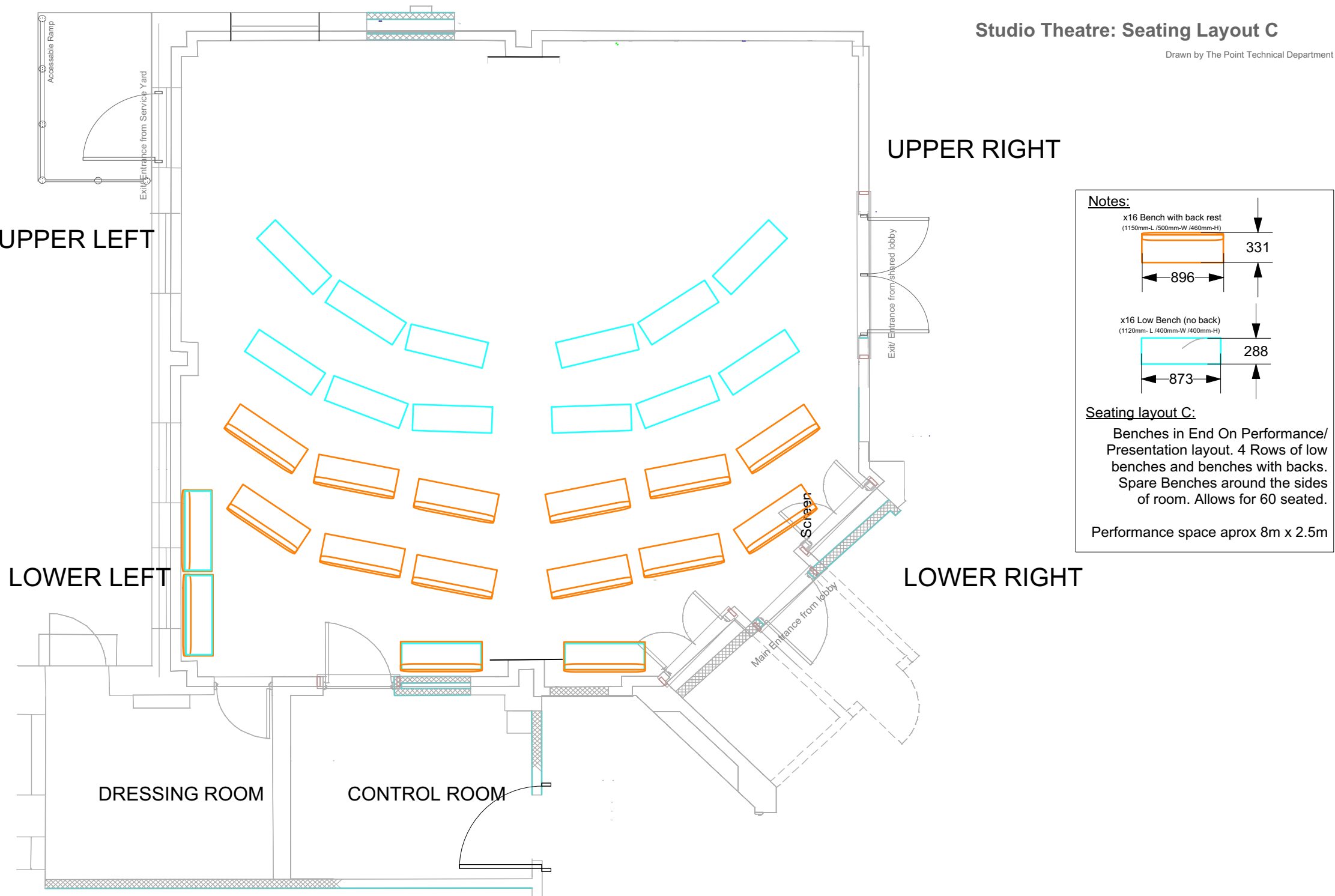

UPPER RIGHT

UPPER LEFT

LOWER LEFT

LOWER RIGHT

DRESSING ROOM

CONTROL ROOM

Notes:

x16 Bench with back rest
(1150mm-L /500mm-W /460mm-H)

896

331

x16 Low Bench (no back)
(1120mm- L /400mm-W /400mm-H)

873

288

Seating layout C:
Benches in End On Performance/
Presentation layout. 4 Rows of low
benches and benches with backs.
Spare Benches around the sides
of room. Allows for 60 seated.

Performance space approx 8m x 2.5m

Studio Theatre: Seating Layout D

Drawn by The Point Technical Department

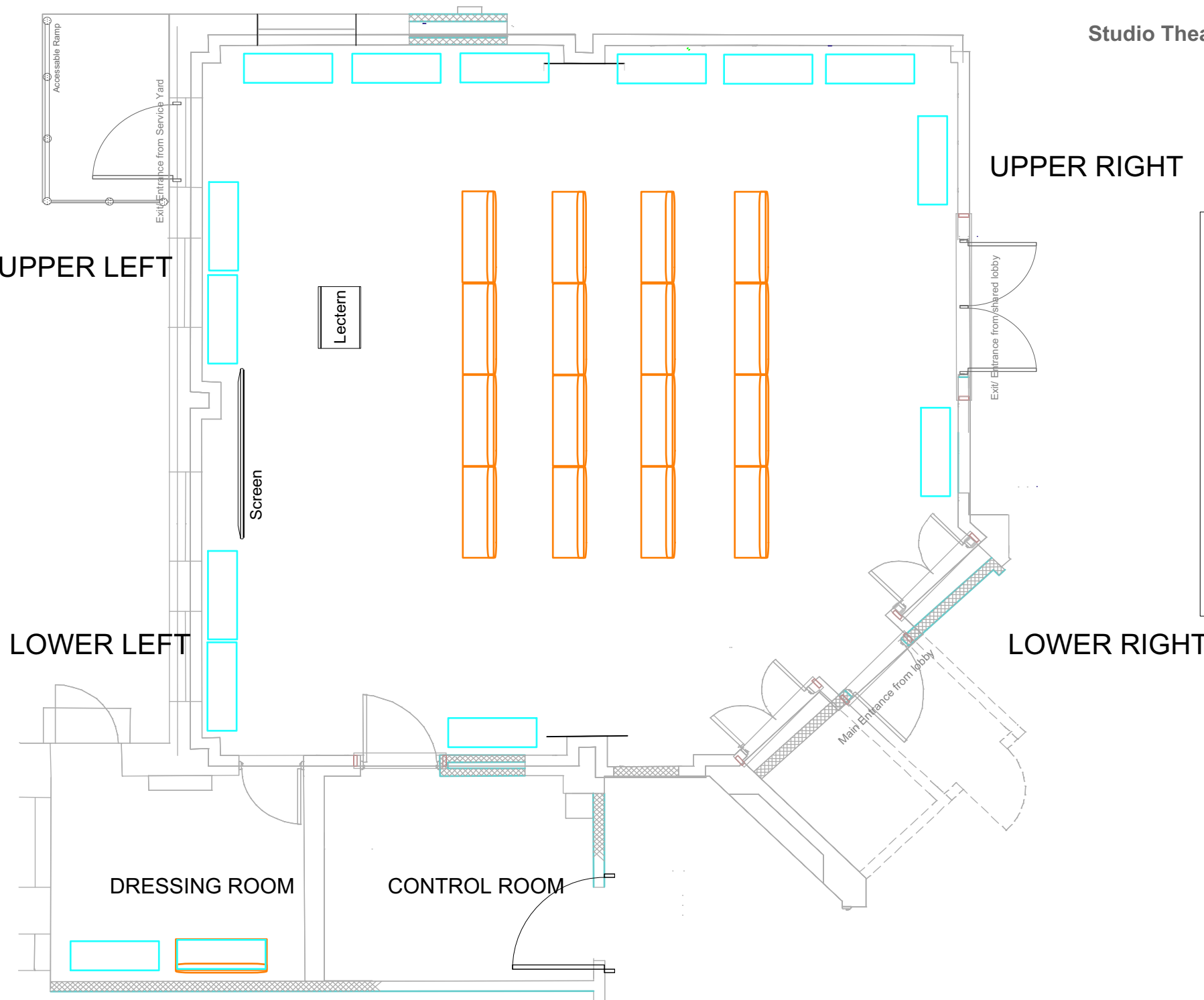

Notes:

x16 Bench with back rest
(1150mm-L /500mm-W /460mm-H)

896

331

x16 Low Bench (no back)
(1120mm- L /400mm-W /400mm-H)

873

288

Seating layout D:
Benches in standard set up for Presentation, all x16 benches with backs in 4 rows. Low benches around the sides of the room. Allows for 44 seated on benches. (Lectern and 70 inch TV for presentaion)